



EIR Ref:2019/012

10th July 2019

REQUEST UNDER ENVIRONMENTAL INFORMATION (SCOTLAND) REGULATIONS 2004

We refer to your request for information, received by email on 20th June 2019. The information you have requested is environmental information, as defined in Regulation 2 of the Environmental Information (Scotland) Regulations 2004 (EIRs). The Park Authority has an obligation to deal with your request under the EIRs and an option to also deal with your request under the Freedom of Information (Scotland) Act 2002 (FOISA), unless the public interest lies in dealing with your request solely under the EIRs. We consider that the public interest in dealing with your request solely under the EIRs outweighs the public interest in also dealing with your request under FOISA, on the basis that the public interest is not served by duplicating consideration of your request under both regimes. We have therefore applied the exemption in section 39(2) of FOISA and dealt with your request under the EIRs alone.

Your specific requests and the response from the National Park Authority are provided below.

“I would request that you provide me with the following information relating to the Luss Visitor Centre:

- a. A copy of the floor plans of all floors of Luss Visitor Centre as part of Application LL 2745 approved by Dumbarton District Council in their letter dated 11 August 1993 to the Loch Lomond Park Authority.”**

West Dunbartonshire Council may have copies of the original plans submitted with these warrants, however we do not hold this information. Accordingly we have to advise under Regulation 10(4)(a) of the EIRs that this information is not held. We have attached copies of information relating to the building warrants held by West Dunbartonshire Council in Appendix A which we hope may be helpful.

- b. “A copy of all the current floor plans for Luss Visitor Centre if different from the floor plans as part of Application LL 2745 approved by Dumbarton District Council in their letter dated 11 August 1993 to the Loch Lomond Park Authority.”**

A copy of the current floor plans for Luss Visitor Centre is attached in Appendix A.

LOCH LOMOND & THE TROSSACHS NATIONAL PARK AUTHORITY

National Park Headquarters, Carrochan, Carrochan Road, Balloch, G83 8EG Long: 4°34'24"W Lat: 56°00'12"N
t: 01389 722600 f: 01389 722633 e: info@lochlomond-trossachs.org w: lochlomond-trossachs.org

Printed on paper sourced from certified sustainable forests

Yours sincerely

Governance & Legal Team
Loch Lomond & The Trossachs National Park Authority

Review Procedure

If you are dissatisfied with this decision, or the way in which the Authority has dealt with your request, you are entitled to require the Authority to review its decision. Please note that in order for a review to take place you are required to:

- Send your request for review in writing, setting out in full the reasons why you are requesting a review.
- Submit your review request within 40 working days of either the date on which you received a response from the Authority or the date by which you should have received a response under the terms of the Freedom of Information (Scotland) Act 2002, whichever is the later.
- address your review request to:

Governance & Legal Team
Loch Lomond & The Trossachs National Park Authority
National Park Headquarters
Carrochan
Carrochan Road
Balloch
G83 8EG
E-mail: info@lochlomond-trossachs.org

The review will be handled by staff who were not involved in the original decision. You will receive notice of the result of your review within 20 working days.

If you are not satisfied with the response to your request for review, you can contact the Scottish Information Commissioner, the independent body which oversees the Freedom of Information (Scotland) Act 2002, at:

Scottish Information Commissioner
Kinburn Castle
Doubledykes Road
St Andrews
Fife
KY16 9DS
Tel: 01334 464610
Website: www.itspublicknowledge.info

LOCH LOMOND & THE TROSSACHS NATIONAL PARK AUTHORITY

National Park Headquarters, Carrochan, Carrochan Road, Balloch, G83 8EG Long: 4°34'24"W Lat: 56°00'12"N
t: 01389 722600 f: 01389 722633 e: info@lochlomond-trossachs.org w: lochlomond-trossachs.org

Printed on paper sourced from certified sustainable forests

EIR 2019-012 WDC Building Warrants for Luss Visitor Centre

Stage 1



Public Access - Building Standards

Search Results - Application Details

Reference Number:	WBC/99/180	
Address of Proposal:	Loch Lomond Visitor Centre Old Luss Road Balloch G83 8QL	
Proposal:	Stage 1 - Erection of Visitor Centre	
Type of Application:	N/A	
Status:	Received	
Decision:	N/A	Case Officer:
Date Received:	31/08/1999	Application Dated: 30/08/1999
Date Issued:		Decision Date:
Date Validated:		Final Completion Cert. Dt:
Work Start Notice:		
Agent Name:	Page and Park Architects	
Agent Address:	The Italian Centre 49 Cochrane Street Glasgow	

Related Pages

- [Online Building Standards Register](#)
- [Weekly Lists - Planning](#)

External Links

- [Scottish Assessors Portal](#)
- [Scottish Building Standards Agency](#)
- [Planning System in Scotland](#)
- [Planning Appeals](#)



Stage 2

Public Access - Building Standards

Search Results - Application Details

Reference Number: WBC/99/18052
Address of Proposal: Loch Lomond Project Old Luss Road Balloch G83 8QW G83 8QL
Proposal: Stage 2 Erection of visitor centre superstructure
Type of Application: N/A
Status: Received
Decision: N/A
Date Received: 18/10/1999
Date Issued:
Date Validated:

Case Officer: SMCM
Application Dated: 20/10/1999
Decision Date:
Final Completion Cert. Dt:

Work Start Notice:

 Microsoft Word Document

Agent Name: Page & Park Architects
Agent Address: The Italian Centre 49 Cochrane Street Glasgow G1 1HL

Related Pages

[Online Building Standards Register](#)
[Weekly Lists - Planning](#)

External Links

[Scottish Assessors Portal](#)
[Scottish Building Standards Agency](#)
[Planning System In Scotland](#)
[Planning Appeals](#)



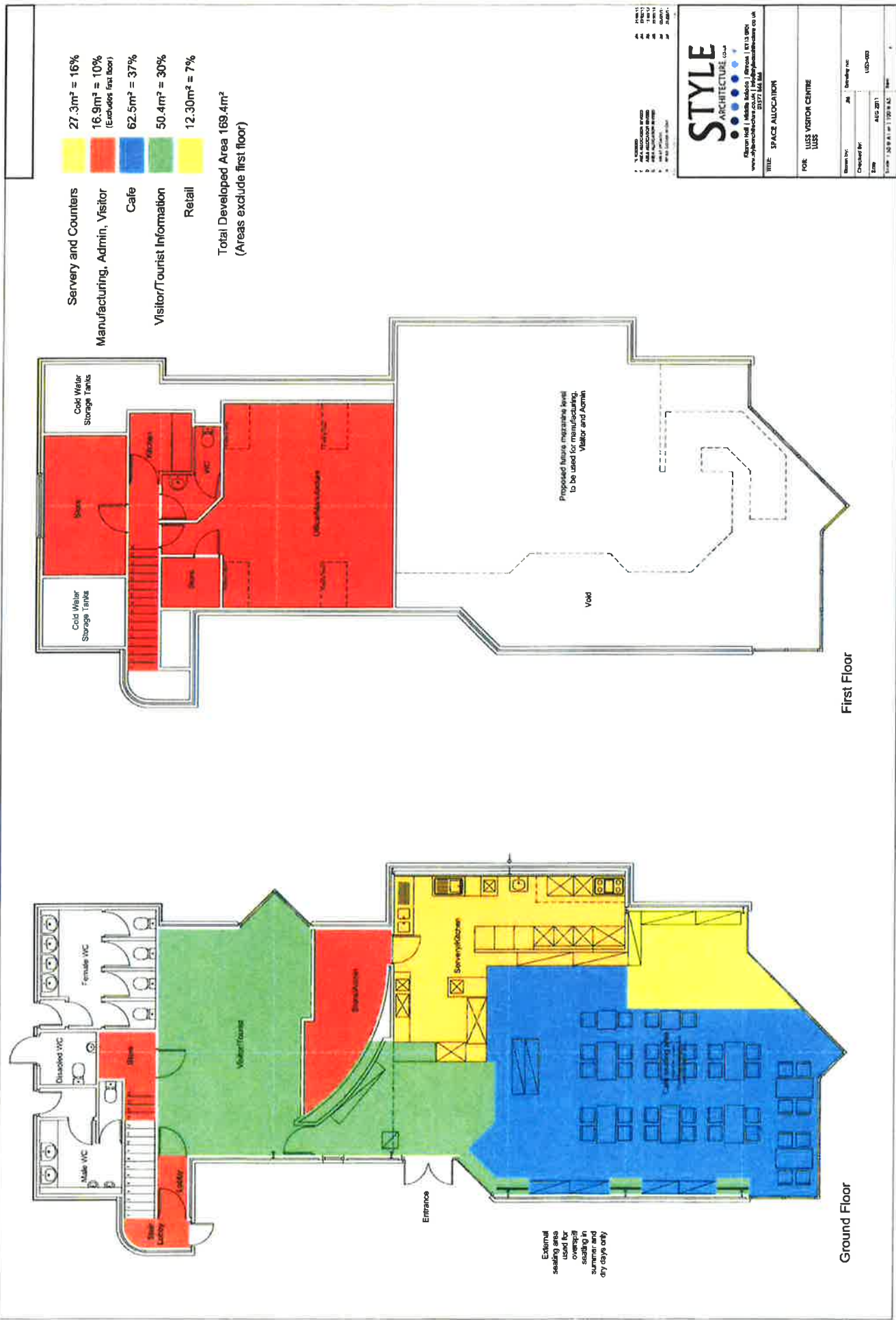

STYLE ARCHITECTURE (L)td
 100, 101, 102, 103, 104, 105, 106, 107, 108, 109, 110, 111, 112, 113, 114, 115, 116, 117, 118, 119, 120, 121, 122, 123, 124, 125, 126, 127, 128, 129, 130, 131, 132, 133, 134, 135, 136, 137, 138, 139, 140, 141, 142, 143, 144, 145, 146, 147, 148, 149, 150, 151, 152, 153, 154, 155, 156, 157, 158, 159, 160, 161, 162, 163, 164, 165, 166, 167, 168, 169, 170, 171, 172, 173, 174, 175, 176, 177, 178, 179, 180, 181, 182, 183, 184, 185, 186, 187, 188, 189, 190, 191, 192, 193, 194, 195, 196, 197, 198, 199, 200, 201, 202, 203, 204, 205, 206, 207, 208, 209, 210, 211, 212, 213, 214, 215, 216, 217, 218, 219, 220, 221, 222, 223, 224, 225, 226, 227, 228, 229, 230, 231, 232, 233, 234, 235, 236, 237, 238, 239, 240, 241, 242, 243, 244, 245, 246, 247, 248, 249, 250, 251, 252, 253, 254, 255, 256, 257, 258, 259, 260, 261, 262, 263, 264, 265, 266, 267, 268, 269, 270, 271, 272, 273, 274, 275, 276, 277, 278, 279, 280, 281, 282, 283, 284, 285, 286, 287, 288, 289, 290, 291, 292, 293, 294, 295, 296, 297, 298, 299, 300, 301, 302, 303, 304, 305, 306, 307, 308, 309, 310, 311, 312, 313, 314, 315, 316, 317, 318, 319, 320, 321, 322, 323, 324, 325, 326, 327, 328, 329, 330, 331, 332, 333, 334, 335, 336, 337, 338, 339, 340, 341, 342, 343, 344, 345, 346, 347, 348, 349, 350, 351, 352, 353, 354, 355, 356, 357, 358, 359, 360, 361, 362, 363, 364, 365, 366, 367, 368, 369, 370, 371, 372, 373, 374, 375, 376, 377, 378, 379, 380, 381, 382, 383, 384, 385, 386, 387, 388, 389, 390, 391, 392, 393, 394, 395, 396, 397, 398, 399, 400, 401, 402, 403, 404, 405, 406, 407, 408, 409, 410, 411, 412, 413, 414, 415, 416, 417, 418, 419, 420, 421, 422, 423, 424, 425, 426, 427, 428, 429, 430, 431, 432, 433, 434, 435, 436, 437, 438, 439, 440, 441, 442, 443, 444, 445, 446, 447, 448, 449, 450, 451, 452, 453, 454, 455, 456, 457, 458, 459, 460, 461, 462, 463, 464, 465, 466, 467, 468, 469, 470, 471, 472, 473, 474, 475, 476, 477, 478, 479, 480, 481, 482, 483, 484, 485, 486, 487, 488, 489, 490, 491, 492, 493, 494, 495, 496, 497, 498, 499, 500, 501, 502, 503, 504, 505, 506, 507, 508, 509, 510, 511, 512, 513, 514, 515, 516, 517, 518, 519, 520, 521, 522, 523, 524, 525, 526, 527, 528, 529, 530, 531, 532, 533, 534, 535, 536, 537, 538, 539, 540, 541, 542, 543, 544, 545, 546, 547, 548, 549, 550, 551, 552, 553, 554, 555, 556, 557, 558, 559, 560, 561, 562, 563, 564, 565, 566, 567, 568, 569, 570, 571, 572, 573, 574, 575, 576, 577, 578, 579, 580, 581, 582, 583, 584, 585, 586, 587, 588, 589, 590, 591, 592, 593, 594, 595, 596, 597, 598, 599, 600, 601, 602, 603, 604, 605, 606, 607, 608, 609, 610, 611, 612, 613, 614, 615, 616, 617, 618, 619, 620, 621, 622, 623, 624, 625, 626, 627, 628, 629, 630, 631, 632, 633, 634, 635, 636, 637, 638, 639, 640, 641, 642, 643, 644, 645, 646, 647, 648, 649, 650, 651, 652, 653, 654, 655, 656, 657, 658, 659, 660, 661, 662, 663, 664, 665, 666, 667, 668, 669, 670, 671, 672, 673, 674, 675, 676, 677, 678, 679, 680, 681, 682, 683, 684, 685, 686, 687, 688, 689, 690, 691, 692, 693, 694, 695, 696, 697, 698, 699, 700, 701, 702, 703, 704, 705, 706, 707, 708, 709, 710, 711, 712, 713, 714, 715, 716, 717, 718, 719, 720, 721, 722, 723, 724, 725, 726, 727, 728, 729, 730, 731, 732, 733, 734, 735, 736, 737, 738, 739, 740, 741, 742, 743, 744, 745, 746, 747, 748, 749, 750, 751, 752, 753, 754, 755, 756, 757, 758, 759, 760, 761, 762, 763, 764, 765, 766, 767, 768, 769, 770, 771, 772, 773, 774, 775, 776, 777, 778, 779, 780, 781, 782, 783, 784, 785, 786, 787, 788, 789, 790, 791, 792, 793, 794, 795, 796, 797, 798, 799, 800, 801, 802, 803, 804, 805, 806, 807, 808, 809, 810, 811, 812, 813, 814, 815, 816, 817, 818, 819, 820, 821, 822, 823, 824, 825, 826, 827, 828, 829, 830, 831, 832, 833, 834, 835, 836, 837, 838, 839, 840, 841, 842, 843, 844, 845, 846, 847, 848, 849, 850, 851, 852, 853, 854, 855, 856, 857, 858, 859, 860, 861, 862, 863, 864, 865, 866, 867, 868, 869, 870, 871, 872, 873, 874, 875, 876, 877, 878, 879, 880, 881, 882, 883, 884, 885, 886, 887, 888, 889, 890, 891, 892, 893, 894, 895, 896, 897, 898, 899, 900, 901, 902, 903, 904, 905, 906, 907, 908, 909, 910, 911, 912, 913, 914, 915, 916, 917, 918, 919, 920, 921, 922, 923, 924, 925, 926, 927, 928, 929, 930, 931, 932, 933, 934, 935, 936, 937, 938, 939, 940, 941, 942, 943, 944, 945, 946, 947, 948, 949, 950, 951, 952, 953, 954, 955, 956, 957, 958, 959, 960, 961, 962, 963, 964, 965, 966, 967, 968, 969, 970, 971, 972, 973, 974, 975, 976, 977, 978, 979, 980, 981, 982, 983, 984, 985, 986, 987, 988, 989, 990, 991, 992, 993, 994, 995, 996, 997, 998, 999, 1000

FOR: LUSS VISITOR CENTRE
LUSS

Drawn by: JH
 Checked by: JH
 Date: AUG 2011
 Title: SPACE ALLOCATION
 UED-002